

# Portrush Recreation Grounds- Community Consultation Event August 2020

Running Order:

1. Introductions
2. Presentation by GM Design
3. Q&A session
4. Close of consultation event



# Portrush Recreation Grounds- Community Consultation Event August 2020

## Introduction

Causeway Coast and Glens Borough Council with the support of the Department for the Communities have commissioned the design for the redevelopment of Portrush Recreation Grounds.

The existing recreation grounds has 8 tarmac tennis courts which are under used.

The existing Bowling pavilion is deemed to be no longer fit for purpose and there is a current lack of provision for all weather training for the bowling club.

Whilst well used the children's play area is of a relatively poor standard and there is no urban sports resource within the recreation grounds.



# Portrush Recreation Grounds- Community Consultation Event August 2020

The proposed scheme is to redevelop the Recreational Grounds in Portrush to provide the following:

- New Adventure play area
- New bowling pavilion and public toilets
- New low level urban sports area
- Championship Bowling Green
- New synthetic bowling green
- Upgrade of public realm within the site with the inclusion of a multi use space.

The project is anticipated to start spring/summer 2021 and take 12 months to complete by spring/summer 2022.



Key:

1. Adventure Play Area
2. Bowling Pavilion & Public Toilets
3. Competition Bowling Green
4. Synthetic Practice Green
5. Multi Use Recreation Space
6. Public Realm integrating with low level urban sports area
7. Bowling Club Parking

Site Overview

# Portrush Recreation Grounds- Community Consultation Event August 2020

- Key:
1. Basket Swing
  2. Twin Rider Seesaw
  3. Cradle Swing
  4. Care Tyre Swing
  5. Jumping Blocks
  6. Recessed Trampoline
  7. Suspension Bridge
  8. Jumping Discs
  9. Seagull Springer
  10. Play Village
  11. Climbing Wall
  12. Inclusive Orbit Roundabout
  13. Slide with Single Step
  14. Climbing Structure
  15. Seating area with canopy structure
- ← Access points



Adventure play area

## Portrush Recreation Grounds- Community Consultation Event August 2020

### Access & Boundaries

The new design includes a secure boundary around the site with controlled gated access points and accessible gradients for ease of access including wheelchair bicycles. A bespoke railing will form the site boundary to the coastal path along Ramore Head connecting with the new public realm layout. The site will be controlled by the Council and is envisaged to be open during daylight hours and will be closed at night time. The access points to the play area will have spring return, self-closing gates, to prevent access from dogs and assist with preventing children wandering out of the site unsupervised. An 1800mm high paladin fence will formulate the remainder of the boundary to enable the play area to be secure at night time.

### Environment and Landscaping

The site contains some coastal planting to assist with place-making and offering a balance between the hard and soft materials palette. A grass embankment will be formed to respond to the change in site levels and will incorporate a new slide connected to a platform that allows users to climb up to the slide feature. Rock features not only create adventure play equipment, but also provide, vertical elements and shelter from the wind. They also aim to assist the new play area to rest suitably within its coastal environment using locally sourced rocks. As the site is located on Ramore Head, it can be exposed to wind and rain, therefore, a new seasonal canopy structure has been included along with vertical windbreak elements to provide sheltered seating areas.



Adventure Play- 3D Concept



Adventure play area- Equipment examples



Adventure play area- Equipment examples

## Bowling Club Facilities

The design team and the Council have carried out consultations with Portrush Bowling Club to prepare a brief to provide a fit for purpose pavilion that will meet their match day needs including:

- Committee room
- Tea prep facilities
- 2No. Changing rooms with Accessible toilets.

## Public Toilets

As part of the design part of the pavilion building provides public toilets accessed separately to the bowling club facilities. It also includes an externally accessed Changing Places facility. These toilet facilities will be managed by the Council. It is envisaged that these will be open during daylight hours and will be closed at night time.

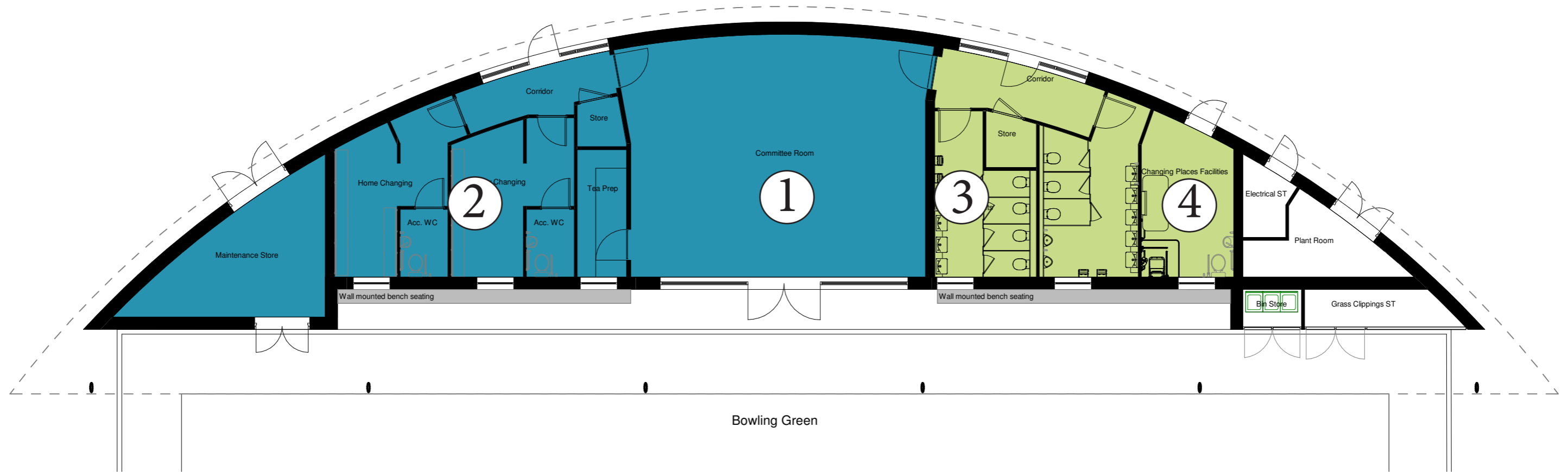

### Key:

1. Bowling Club Committee room
2. Bowling Club Changing facilities
3. Public Toilets
4. Changing Places Facility

Pavilion building





Pavilion building- 3D Concept

# Portrush Recreation Grounds- Community Consultation Event August 2020

The design team and the Council have carried out consultations with the local urban sports group to appropriately locate the area on the site using existing landforms to create shelter from the prevailing elements.

The initial concept idea provides a 766m<sup>2</sup> space which can be used daily by all abilities. It is also set out to create a 'course' around the entire area. The internal area consists of grind rails, fun boxes and a pyramid ramp to provide varying levels of difficulties for all ages and abilities to use the space.

Key:

- 1. Staging Area 1
- 2. Staging area 2
- 3. Grind Rails
- 4. Funbox
- 5. Pyramid
- 6. Bowl
- 7. Roll in
- 8. Stairs, Hubba & Rail
- 9. Bank/ Wedge Ramp

← Access points

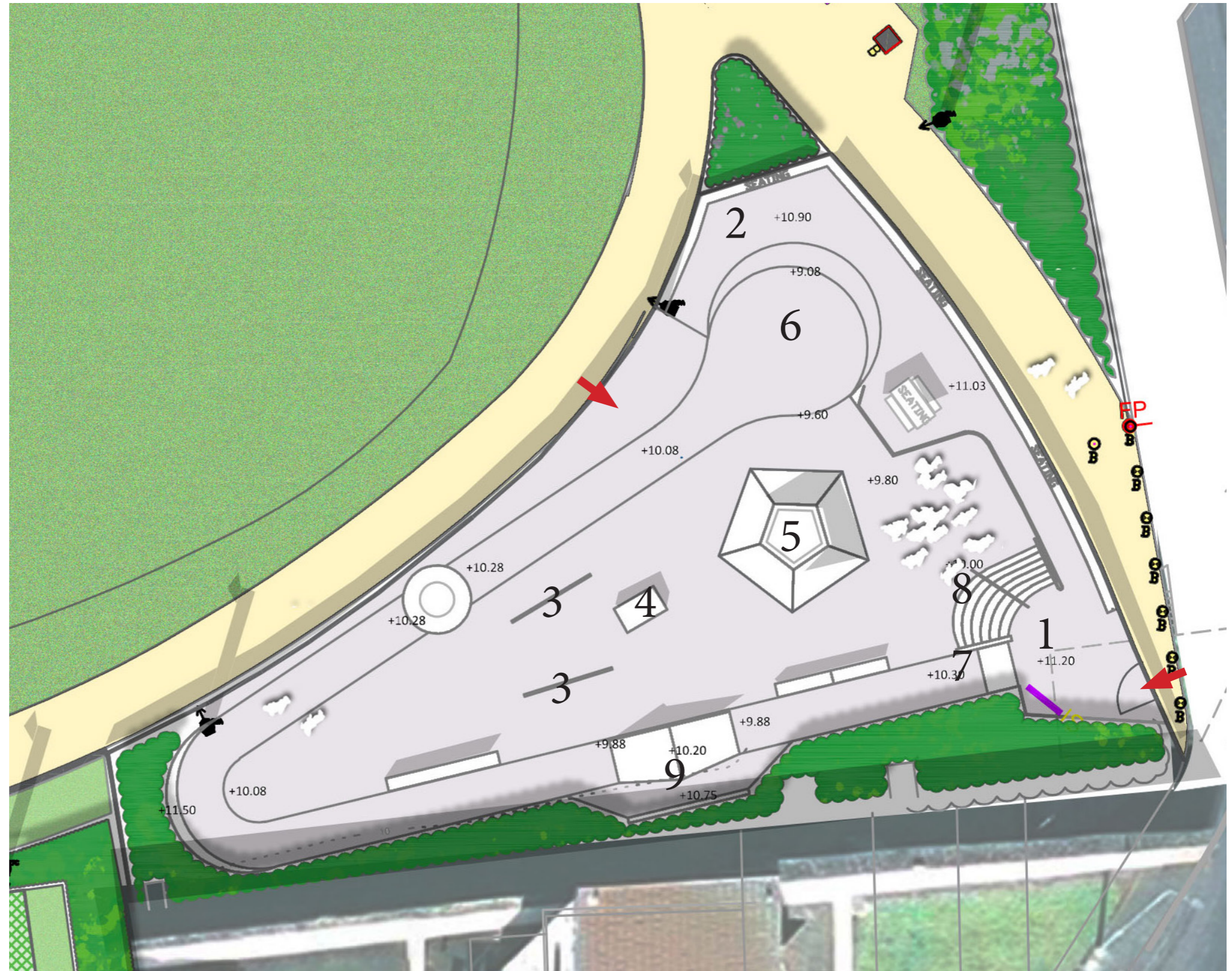

Low Level Urban sports area



Low Level Urban sports- 3D Concept

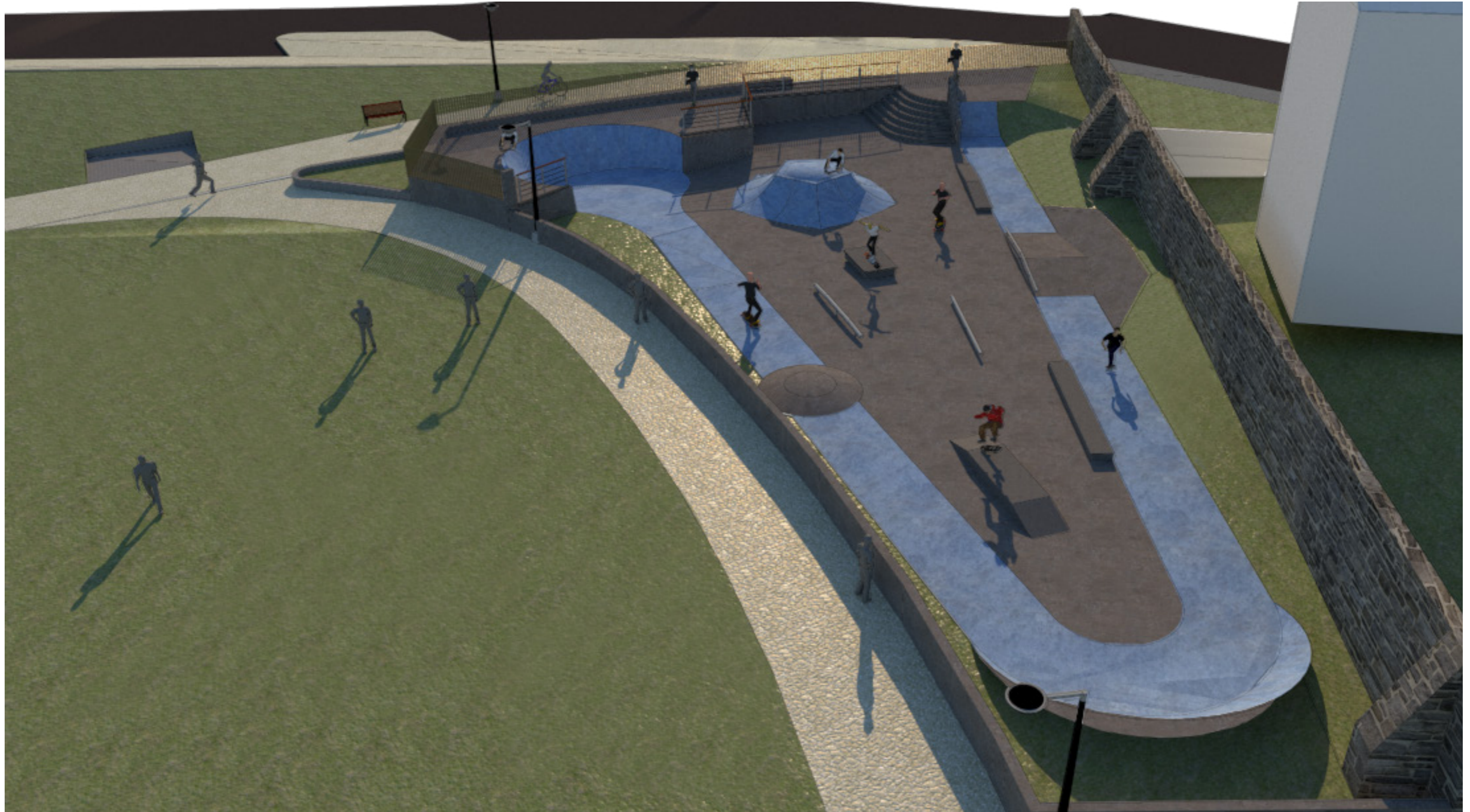

Low Level Urban sports- 3D Concept

# Portrush Recreation Grounds- Community Consultation Event August 2020

The multi use recreation space is 3930m<sup>2</sup> it will be used on a daily basis as open parkland.

As indicated by the band circles the national pipe band championships could be held here as well as occasional farmers markets or additional event areas for the air show etc.

There are many opportunities for seating around the events space in the form of permanent street furniture and by way of natural incidental seating created by the landscaped areas on the site.

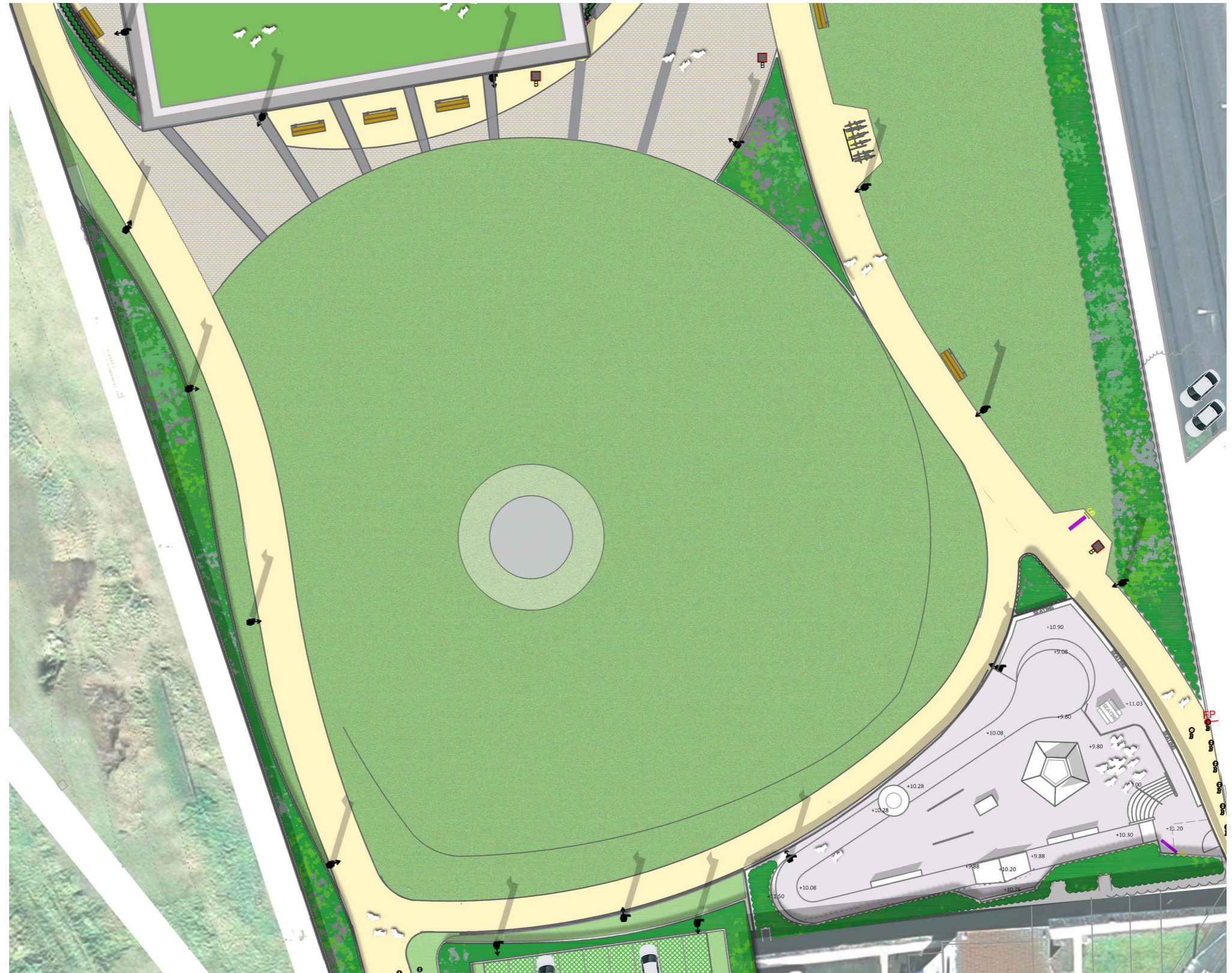

Multi Use Recreation Space

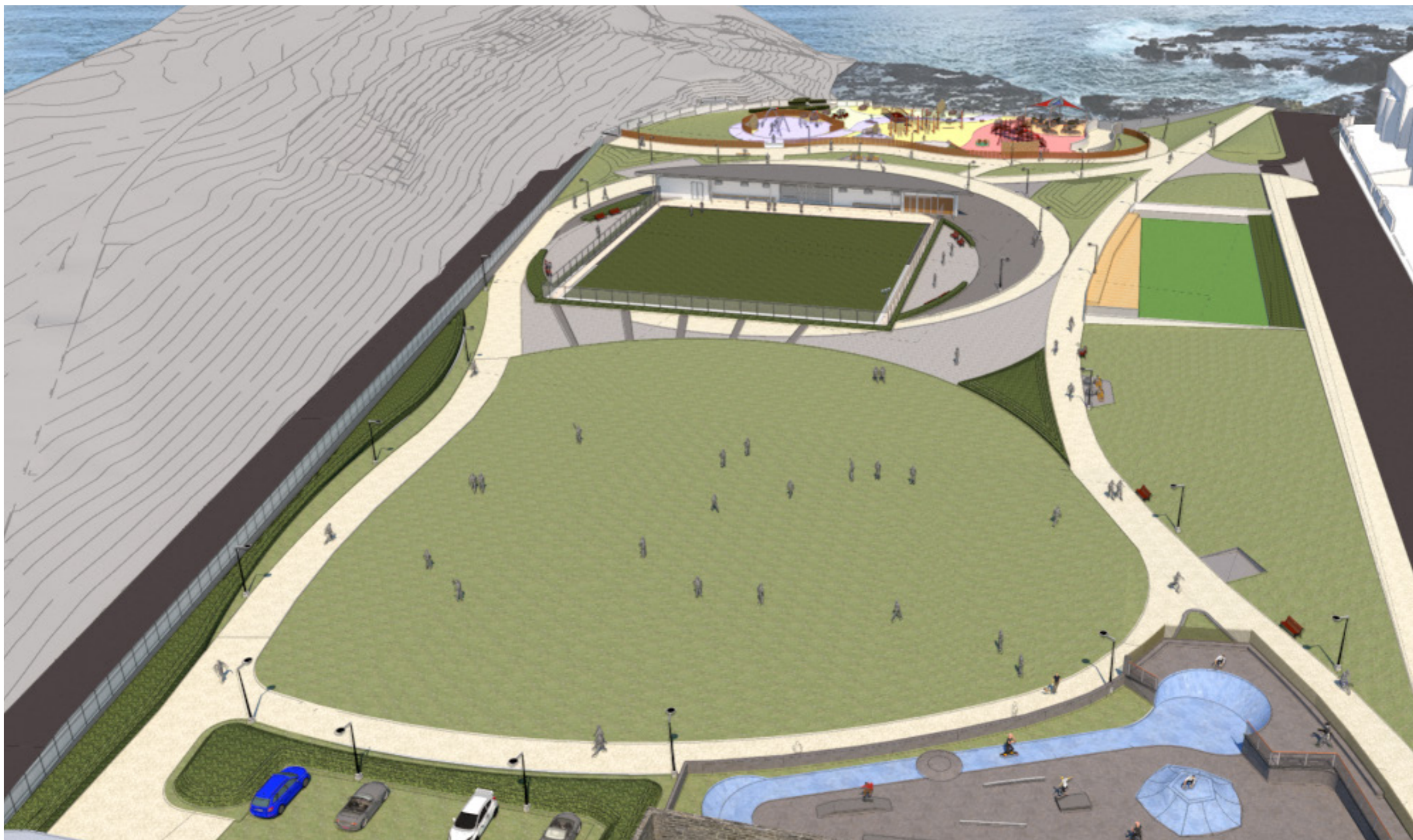

Recreation Grounds- 3D Concept

## Question & Answer Session

If you would like to speak, you have the following options:

- Raise your hand, or
- Use the Q&A panel to submit written comments.

You can 'upvote' questions by other attendees by using the like button beside the question.

All questions will be saved and if we do not get through them all in this session we will endeavour to respond to you after the event via email.



## Portrush Recreation Grounds- Community Consultation Event August 2020

Thank you for participating in today's event, please see below details on where to find the event material and feedback form.

Further information on the proposed improvement works and consultation exercise is available on the Council's website.

<https://www.causewaycoastandglens.gov.uk/council/council-consultations>

This event material and a questionnaire/feedback form is available online and physical information/display boards are displayed at the Portrush Recreation Grounds. Anyone wishing to comment on the proposal may do so by completing an online questionnaire/feedback form or by providing comment to the design team at

GM Design Associates Ltd  
via post to **22 Lodge Road, Coleraine, BT52 1NB**,  
via email to **[gmda@g-m-design.co.uk](mailto:gmda@g-m-design.co.uk)**  
or by phone on **028 703 56138**.  
Comments should be provided no later than **4th September 2020**.

Please note that comments made about the proposal during this consultation period are no representations to the Planning Authority. If the prospective applicant proceeds with an application there will be an opportunity to make representations on that application to the Planning Authority at a later stage.